

Foldable height adjustable arms for Chiro and Luna

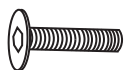

A*2PCS



B*6PCS
(M6*36mm)



C*6PCS
(M6*16mm)

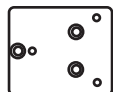

D*2PCS



E*1PC



F*1PC

NOTE:

THE IMAGE SHOWS THE CHIRO MECHANISM –
THE LUNA IS THE SAME BUT WITHOUT THE SEAT
SLIDE.

THE ARM ASSEMBLY IS THE SAME.

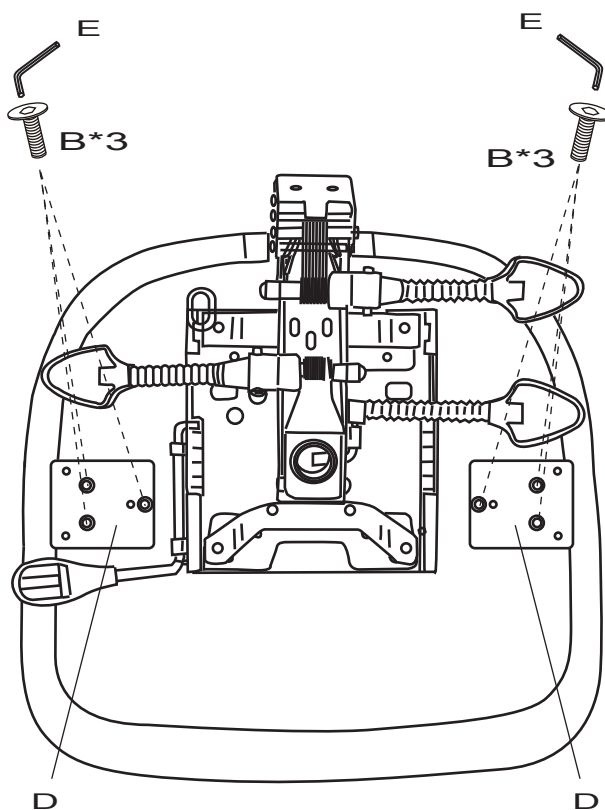

Stage 1

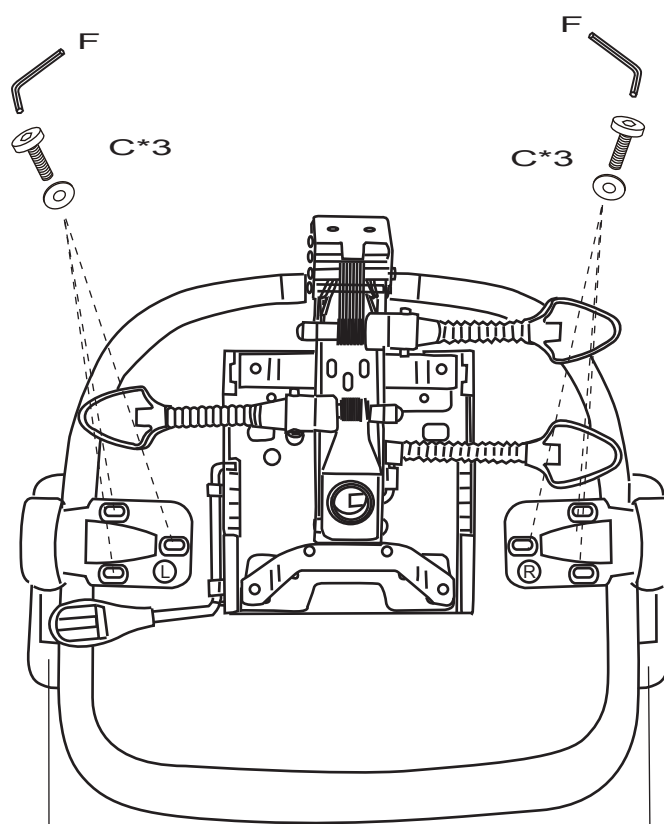

A-LEFT

Stage 2

A-RIGHT

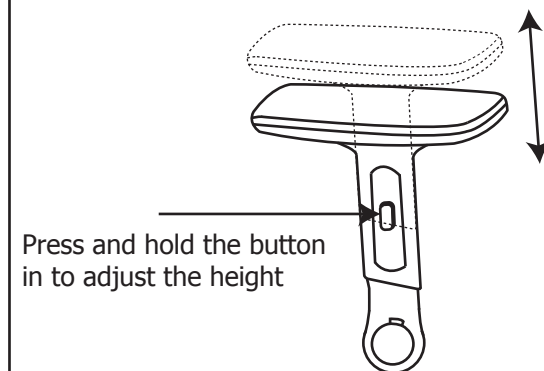

Press and hold the button
in to adjust the height

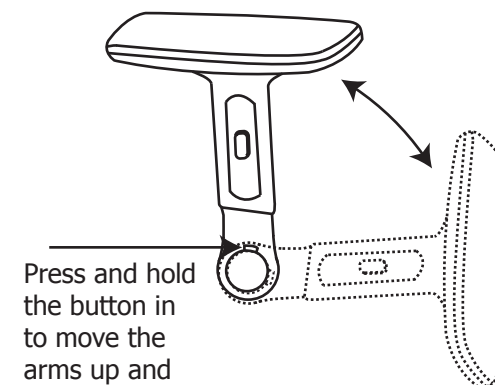

Press and hold
the button in
to move the
arms up and
down